

AT A GLANCE

FEATURES

- Stylish top mount control
- Single action design (one lever for throttle one for shift)
- CH5600P patented SLT technology prevents throttle creep
- Superior twin station performance
- Polished stainless steel levers and cover
- Positive detents for shift
- Push or pull to operate throttle and/or shift
- Includes hardware for two 33C type cables
- Optional neutral safety switch

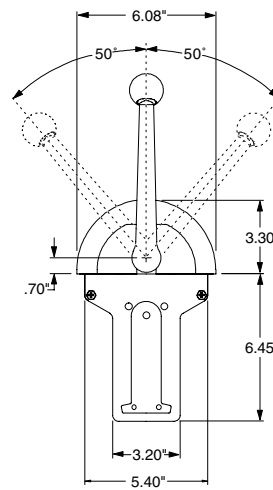
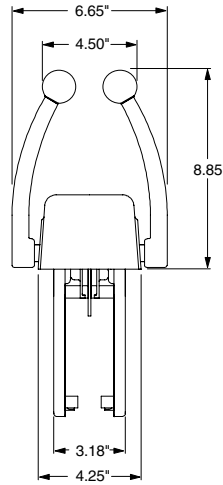

CH5600P TOP MOUNT CONTROLS

TECHNICAL DATA

For single or dual stations with single or twin engines. One control per engine per station. Using a patented self locking throttle clutch (SLT), the CH5600P control fights throttle creep without friction devices, for a smoother feel.

SPECIFICATIONS

| ORDER INFORMATION | PART NO. |
|-------------------------------|----------------|
| CH5600P SLT top mount control | CH5600P |

| ACCESSORIES AND PARTS | PART NO. |
|---|-------------------|
| Optional neutral safety switch | CA69009P |
| Cable attachment kit (3300/dual sta) | CA69022P |
| 3300 heavy duty brass pivot kit | CA27563P |
| Replacement red knob | 4009912** |
| Replacement black knob | 4009819** |
| Stainless steel throttle knob (grooved) | CA69052P** |
| Stainless steel shift knob (smooth) | CA69051P** |
| CH5600 mounting hardware kit | CA69013P |
| Replacement stainless steel lever | CA69060P |

| COMPATIBLE CABLES | PART NO. |
|-----------------------------------|------------------------|
| OEM/Univ. 3300 Types | |
| Mercury 3600 type cable (premium) | CCX630XX |
| Universal 3300 Types | |
| 3300 cable (standard) | CC172XX/CC230XX |
| 3300 cable (midrange) | CC332XX |
| TFXTREME 3300 cable (premium) | CCX633XX |

** Fits most controls with 3/8-24 threaded levers

